

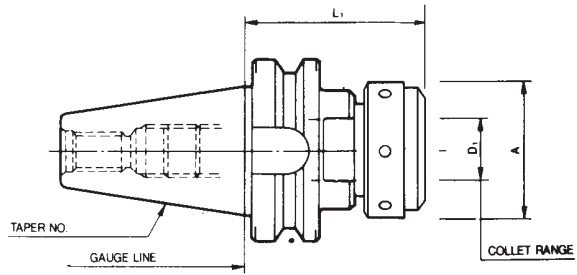

# TG Collet Chucks

## BT & CT Flange Tools TG Collet Chucks

For use with TG style collets. See pages 3-1 and 3-2 for collet information



### BT

Taper	Order No.	Device Type	D1 (in)	L1 (in)	A (in)
30	473-400	BT30 - TG75 - 63.5	0.046 - 0.750	2.50	1.875
30	473-405	BT30 - TG100 - 101.6	0.063 - 1.000	4.00	2.50
40	473-100	BT40 - TG75 - 76.2	0.046 - 0.750	3.00	1.875
40	473-105	BT40 - TG100 - 100	0.063 - 1.000	3.94	2.50
40	473-106	BT40 - TG100 - 133	0.063 - 1.000	5.25	2.50
40	473-107	BT40 - TG100 - 184	0.063 - 1.000	7.25	2.50
45	473-215*	BT45 - TG150 - 100	0.500 - 1.500	3.94	3.25
50	473-305	BT50 - TG100 - 100	0.063 - 1.000	3.94	2.50
50	473-306	BT50 - TG100 - 152	0.063 - 1.000	6.00	2.50

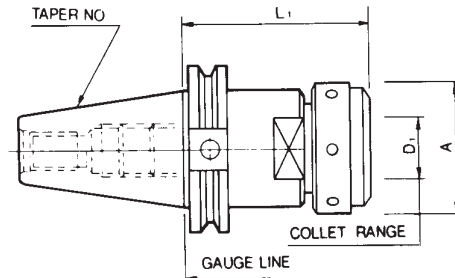

### CT

Taper	Order No.	Device Type	D1 (in)	L1 (in)	A (in)
40	474-100	CT40 - TG75 - 3.00	0.046 - 0.750	3.00	1.875
40	474-105	CT40 - TG100 - 3.25	0.063 - 1.000	3.25	2.50
40	474-106	CT40 - TG100 - 5.25	0.063 - 1.000	5.25	2.50
40	474-107	CT40 - TG100 - 7.25	0.063 - 1.000	7.25	2.50
45	474-205*	CT45 - TG100 - 3.13	0.063 - 1.000	3.13	2.50
45	474-206*	CT45 - TG100 - 5.13	0.063 - 1.000	5.13	2.50
45	474-207*	CT45 - TG100 - 7.13	0.063 - 1.000	7.13	2.50
50	474-305	CT50 - TG100 - 3.13	0.063 - 1.000	3.13	2.50
50	474-306	CT50 - TG100 - 5.13	0.063 - 1.000	5.13	2.50
50	474-307	CT50 - TG100 - 7.13	0.063 - 1.000	7.13	2.50
50	474-315	CT50 - TG150 - 3.50	0.500 - 1.500	3.50	3.25

\* While stock is still available.





# TG Collet Chucks Balanced G6.3

## BT & CT Flange Tools

For use with TG style  
collets. See pages 3-1 and  
3-2 for collet information

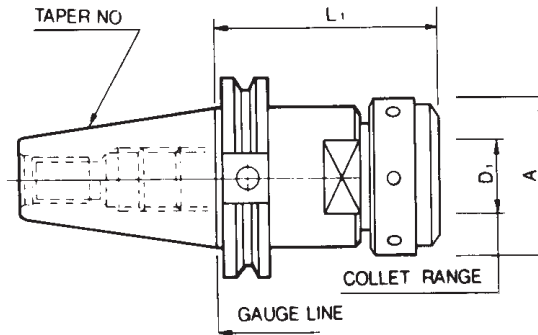

### BT Taper



Taper	Order No.	Device Type	Collet Style	D <sub>1</sub> Collet Range (in)	L <sub>1</sub> (in)	A (in)	Max RPM
30	473-000-B	BT30-TG75-63.5	TG75	0.046-0.750	2.50	1.875	15,000
30	473-005-B	BT30-TG100-100	TG100	0.063-1.000	3.94	2.50	15,000
40	473-200-B	BT40-TG75-76.2	TG75	0.046-0.750	3.00	1.875	15,000
40	473-205-B	BT40-TG100-100	TG100	0.063-1.000	3.94	2.50	15,000
40	473-206-B	BT40-TG100-133	TG100	0.063-1.000	5.25	2.50	15,000
40	473-207-B	BT40-TG100-184	TG100	0.063-1.000	7.25	2.50	10,000
50	473-405-B	BT50-TG100-100	TG100	0.063-1.000	3.94	2.50	12,000
50	473-406-B	BT50-TG100-152	TG100	0.063-1.000	6.00	2.50	10,000

### CT Taper



Taper	Order No.	Device Type	Collet Style	D <sub>1</sub> Collet Range (in)	L <sub>1</sub> (in)	A (in)	Max RPM
40	474-200-B	CT40-TG75-3.00	TG75	0.046-0.750	3.00	1.875	15,000
40	474-205-B	CT40-TG100-3.25	TG100	0.063-1.000	3.25	2.50	15,000
40	474-206-B	CT40-TG100-5.25	TG100	0.063-1.000	5.25	2.50	15,000
40	474-207-B	CT40-TG100-7.25	TG100	0.063-1.000	7.25	2.50	10,000
50	474-405-B	CT50-TG100-3.13	TG100	0.063-1.000	3.13	2.50	12,000
50	474-406-B	CT50-TG100-5.13	TG100	0.063-1.000	5.13	2.50	10,000

NOTE: Achieving maximum rotation speed depends on the concentricity and symmetry of the cutting tool and the complete tool assembly.



# TG Collet Chucks

## DIN 69871-Form B

### Coolant Through The Flange

### CT Flange Tools

For use with TG style coolant sealed collets.  
See pages 3-3 for collet information.

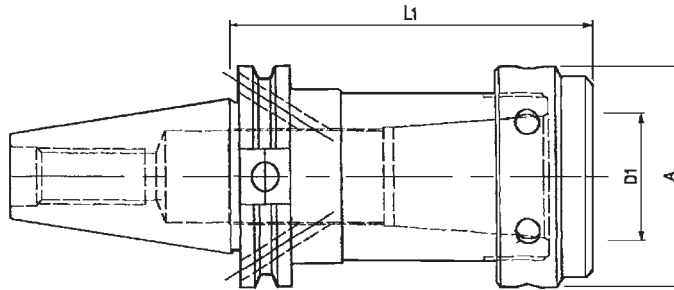

### CT Taper

Taper	Order No.	Device Type	Collet Style	D <sub>1</sub> Collet Range (in)	L <sub>1</sub> (in)	A (in)	Max RPM
40	474-205-D	CT40D-TG100-3.25	TG100	0.063-1.000	3.25	2.50	15,000
40	474-206-D	CT40D-TG100-5.25	TG100	0.063-1.000	5.25	2.50	15,000
40	474-207-D	CT40D-TG100-7.25	TG100	0.063-1.000	7.25	2.50	10,000
50	474-405-D	CT50D-TG100-3.13	TG100	0.063-1.000	3.13	2.50	15,000
50	474-406-D	CT50D-TG100-5.13	TG100	0.063-1.000	5.13	2.50	10,000
50	474-407-D	CT50D-TG100-7.13	TG100	0.063-1.000	7.13	2.50	8,000

NOTE: Achieving maximum rotation speed depends on the concentricity and symmetry of the cutting tool and the complete tool assembly.

# R8 & NMTB-QC, TG Collet Chucks

## TG Collet Chucks

NMTB tool holders are qualified for use with Erickson QC spindles.

For TG Collets, see pages 3-1 to 3-2.

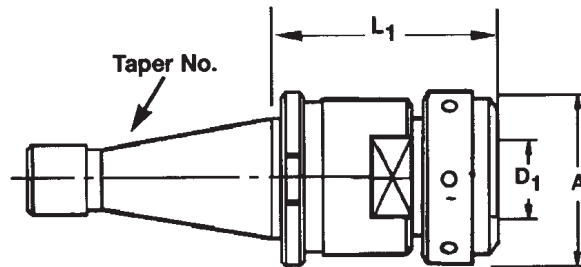

**NMTB**

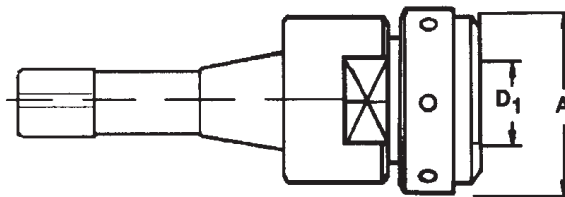

**R8**



Taper	Order No.	Device Type	D <sub>1</sub> (in)	L <sub>1</sub> (in)	A (in)
30	674-000	NMTB30QC – TG75-2.50	0.046 – 0.750	2.50	1.875
30	674-005	NMTB30QC – TG100-4.00	0.063 – 1.000	4.00	2.50
40	674-200	NMTB40QC – TG75-2.50	0.046 – 0.750	2.50	1.875
40	674-205	NMTB40QC – TG100-3.00	0.063 – 1.000	3.00	2.50
50	674-405	NMTB50QC – TG100-3.50	0.063 – 1.000	3.50	2.50
R8	674-805	R8-TG100	0.063 – 1.000	–	2.50