

ECX (ER) Superflex Precision Collet Chucks – Extensions

STRAIGHT SHANK

BACK-UP SCREW

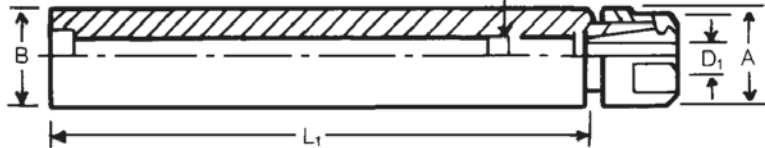

Mini Nuts

Order No.	Device Type	B (in)	L ₁ (mm/in)	Collet Range D ₁ (in)	A (mm)	Nut Style
008-000	ECX/ER8 EXTENSION	0.375"	100/3.94	0.020-0.197	12	M
011-000	ECX/ER11 EXTENSION	0.500"	166.5/6.53	0.020-0.275	16	M
016-004	ECX/ER16 EXTENSION	0.500"	140/5.51	0.020-0.394	22	M
016-005	ECX/ER16 EXTENSION	0.750"	177.8/7.00	0.020-0.394	22	M
016-006	ECX/ER16 EXTENSION	0.750"	140/5.51	0.020-0.394	22	M
021-005	ECX/ER20 EXTENSION	0.500"	140/5.51	0.020-0.512	28	M
021-006	ECX/ER20 EXTENSION	0.750"	169.5/6.67	0.020-0.512	28	M
025-005	ECX/ER25 EXTENSION	0.750"	100/3.94	0.020-0.630	35	M
025-006	ECX/ER25 EXTENSION	1.000"	140/5.51	0.020-0.630	35	M

Standard Nuts

Order No.	Device Type	B (in)	L ₁ (mm/in)	Collet Range D ₁ (in)	A (in)	Nut Style
016-000	ECX/ER16 EXTENSION	0.750"	139.7/5.50	0.020-0.394	1.100	H
021-000	ECX/ER20 EXTENSION	1.000"	139.95/5.51	0.020-0.512	1.250	H
025-000	ECX/ER25 EXTENSION	1.000"	146.05/5.75	0.020-0.630	1.684	C
032-000	ECX/ER32 EXTENSION	1.250"	144.78/5.70	0.079-0.787	1.969	C
032-001	ECX/ER32 EXTENSION	1.000"	50/1.97	0.079-0.787	1.969	C
032-002	ECX/ER32 EXTENSION	1.000"	140/5.57	0.079-0.787	1.969	C
040-000	ECX/ER40 EXTENSION	1.000"	50/1.97	0.118-1.023	2.480	C
040-001	ECX/ER40 EXTENSION	1.250"	66.3/2.375	0.118-1.023	2.480	C
040-002	ECX/ER40 EXTENSION	1.500"	145/5.510	0.118-1.023	2.480	C

NUT STYLES

C = CASTELLATION
H = HEXAGON
M = MINI CASTELLATION

THEORETICAL MAX

Tightening Torque for ER/ECX nuts

ECX/ER8M	12Nm/9FT/lbs
ECX/ER11M	25Nm/18FT/lbs
ECX/ER16M	35Nm/25FT/lbs
ECX/ER16	80Nm/60FT/lbs
ECX/ER20M	40Nm/29FT/lbs
ECX/ER20	110Nm/80FT/lbs
ECX/ER25M	45Nm/33FT/lbs
ECX/ER25	140Nm/103FT/lbs
ECX/ER32	180Nm/132FT/lbs
ECX/ER40	230Nm/169FT/lbs

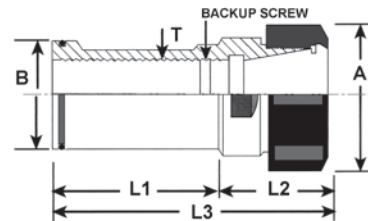

CNC Lathe ECX/ER Collet Extensions

Order No.	Device Type	B (in)	L ₁ (mm)	L ₂ (mm)	L ₃ (mm)	A (mm)	Backup Screw
025-010	ECX25	1-1/4	60	47	107	42	M18 x 1.5
032-010	ECX32	1-1/4	60	58	118	50	M22 x 1.5
040-010	ECX40	1-1/4	60	60	120	63	M28 x 1.5
032-011	ECX32	1-1/2	80	58	138	50	M22 x 1.5
040-011	ECX40	1-1/2	75	60	135	63	M28 x 1.5