

ECX (ER) Superflex Collet Chucks for CNC Routers

TOOLHOLDERS & AUXILIARY PRODUCTS

For use with ER/ECX style collet chucks. See pages 3-7 to 3-11 for collet information.

For collet nuts and wrenches see pages 1-21 to 1-22 and 3-16 to 3-18.

For use with 462E/SYOZ25 style collet chucks. See pages 3-31 for collet information.

ER/ECX



SYOZ/RDO



Fig.1

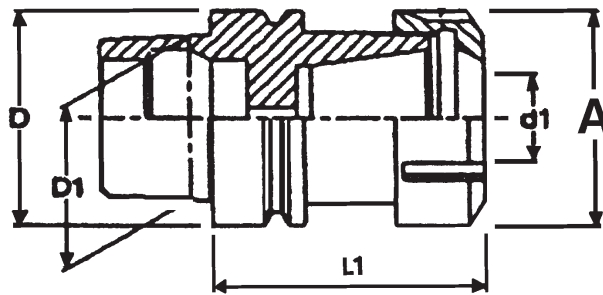

NUT STYLES

C = CASTELLATION
H = HEXAGON
S = SPANNER

THEORETICAL MAX

Tightening Torque for ER/ECX nuts

ECX/ER32	180Nm/132FT/lbs
ECX/ER40	230Nm/169FT/lbs.
RDK25/462E	180Nm/132FT/lbs

HSK-F

Taper	Order No.	Device Type	Collet	D ₁ (in) Collet Range	L ₁ (mm)	A (in)	Max RPM	Nut Style
63F	584-532F	HSK63F-ECX32-60 mm	ECX/ER32	0.059 - 0.787	60	1.97	25,000	C
63F	584-540F	HSK63F-ECX40-60 mm	ECX/ER40	0.112 - 1.024	60	2.48	25,000	C
63F	584-5025F	HSK63F-NO.25-60 mm	462E/SYOZ25	0.125 - 1.000	60	2.36	25,000	S