



1 • Detection of Operating Location With attached proximity switch, it can be used for interface of automated devices because it is able to detect the movement of cylinder pistons. **2 • Miniaturization & Lightness** As it adopts non-contact method of small detection rings, it is hardly defective and has excellent safety at high speed rotation. **3 • High Performance and High Quality** With a proximity switch attached to YAS cylinder, it guarantees excellent performance and quality.

1 • 检测运行情况: 由于此型号回转油缸带接近开关, 可与自动控制装置连接, 来检测回转油缸活塞的运行情况. **2 • 体积小, 重量轻:** 此回转油缸采用非接触式小检测测环, 因此确保其具高速旋转的安全性. **3 • 性能优, 质量好:** 此型号的回转油缸是带单向阀的YAS型回转油缸. 因此可保证优良的性能和质量.

1 • 작동 위치 검출 2 • 소형 경량화 3 • 고성능, 고품질

1 • 작동 위치 검출 2 • 소형 경량화 3 • 고성능 · 고품질

Outward Drawing / 外形图 / 外形图 / 외형도

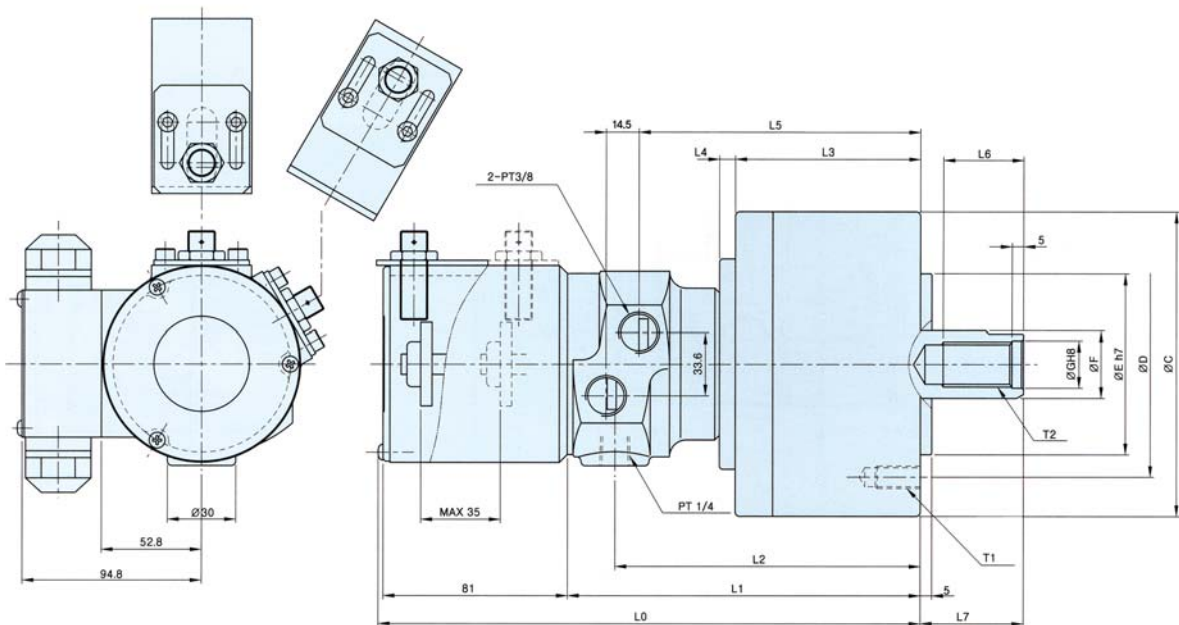

Dimension / 尺寸 / 寸法表 / 치수표

Model 형식	C	D	E	F	G	L0	L1	L2	L3	L4	L5	L6	L7 max	L7 min	T1	T2
YASP-100	135	100	80	30	21	236	155	134	81.5	6.5	123.5	35	45	25	6-M10X19	M20XP25
YASP-125	160	130	110	35	25	246	165	144	91.5	6.5	133.5	40	50	25	6-M12X22	M24XP30
YASP-150	185	130	110	45	30.5	253	172	151	98.5	6.5	140.5	45	55	25	6-M12X20	M30XP3.5
YASP-200	245	145	120	55	37	276.5	195.5	174.5	122	6.5	164	60	69	34	6-M16X29	M36XP4.0

Specifications / 规格 / 仕様表 / 사양표

Spec 사양	Order NO. 주문번호	Cylinder Dia 실린더내경 mm	Piston stroke 피스톤스트로크 mm	Piston surface area 피스톤 단면적 cm ²		Max. Draw bar pull 실린더 추력 KN(kgf)	
				Extend 압축	Retract 인축	Extend 압축	Retract 인축
YASP-100	2ASP10	105	20	86.5	79.5	31.8(3244)	29.3(2989)
YASP-125	2ASP12	130	25	132.5	123.0	48.8(4978)	45.3(4621)
YASP-150	2ASP15	150	30	176.0	160.0	64.8(6610)	60.0(6120)
YASP-200	2ASP20	205	35	330.0	306.0	121.6(12404)	112.8(11505)

Spec 사양	Max. operating pressure 최고사용유압력 kgf/cm ²	Max. permissible speed 최고사용회전수 r.p.m.(min ⁻¹)	Total leakage 총드레인량 ℓ/min	Weight 중량 kg	GD ² Moment of inertia N·m ² (kgf·m ²)	Matching chuck 적용척
YASP-100	40.8	6000	1.0	5.8	0.49(0.05)	CAS-06
YASP-125	40.8	6000	1.0	7.9	0.88(0.09)	CAS-08, CAS-10
YASP-150	40.8	5500	1.0	10.8	1.47(0.15)	CAS-10, CAS-12
YASP-200	40.8	5500	1.0	20.0	3.62(0.37)	CAS-15이상