

# Boring Bar Blanks

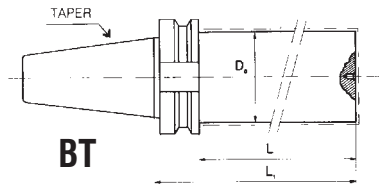

**BT & CT  
Flange Tools**

## Boring Bar Blanks



**BT**

Taper	Order No.	Device Type	D <sub>0</sub>	L (in)	L <sub>1</sub> (in)
40	507-899	BT40 - BBB-6225	2.50	11.875	13.00
50	507-991	BT50 - BBB-9025	4.00	11.570	13.00

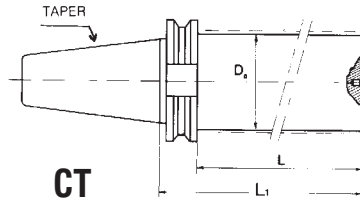

**CT**

Taper	Order No.	Device Type	D <sub>0</sub>	L (in)	L <sub>1</sub> (in)
40	509-899	CT40 - BBB-6225	2.50	12.00	13.00
50	509-991	CT50 - BBB-9025	4.00	11.570	13.00

# Toolholder Blanks

## HSK-A Flange Tools

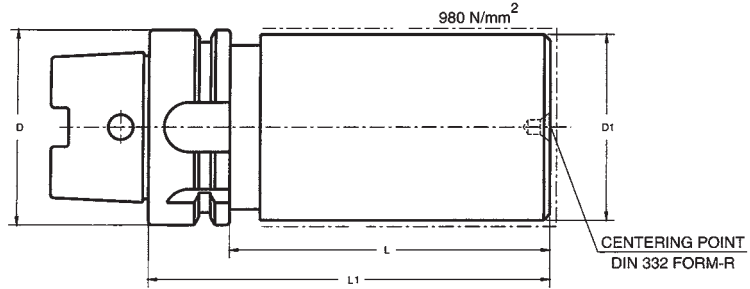

Taper	Order No.	Device Type	D <sub>1</sub> (mm)	L (mm)	L <sub>1</sub> (mm)
40	599-300A	HSK40A-THB4010	40	80	100
50	599-400A	HSK50A-THB5010	50	74	100
50	599-405A	HSK50A-THB6316	63	134	160
63	599-500A	HSK63A-THB6310	63	74	100
63	599-505A	HSK63A-THB8016	80	134	160
63	599-510A	HSK63A-THB8025	80	224	250
80	599-600A	HSK80A-THB8016	80	134	160
100	599-700A	HSK100A-THB10016	100	131	160

## HSK-E Flange Tools

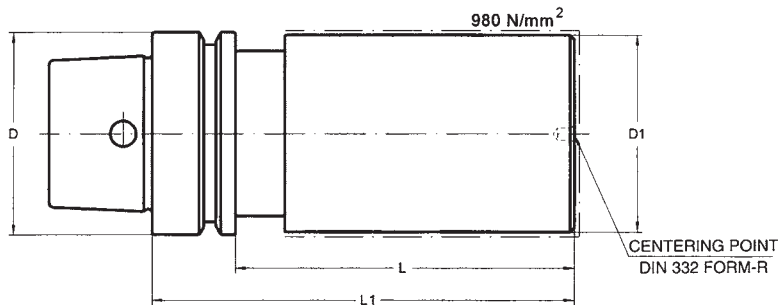

Taper	Order No.	Device Type	D <sub>1</sub> (mm)	L (mm)	L <sub>1</sub> (mm)
25	599-100E	HSK25E-THB2510	25	80	100
32	599-200E	HSK32E-THB3210	32	80	100
40	599-300E	HSK40E-THB4010	40	80	100
50	599-400E	HSK50E-THB5010	50	74	100
63	599-500E	HSK63E-THB6310	63	74	100